

### SERVICES SCHEDULE

STREET NAME	GAS	D-WATER	TELSTRA	ELECT.	SEWER	TREES BOTH SIDES	ROAD RESERVE
INNSBRUCK ROAD	3.30 E	4.10 E	1.85 W	2.55 W	1.00 E	1.00 B.O.K.	24.00
REVELSTOKE WAY	2.30 N	2.75 N	1.80 S	2.40 S	1.00 N	1.00 B.O.K.	16.00
TAHOE AVENUE	2.30 W	2.75 W	1.85 E	2.60 E	1.00 E	1.00 B.O.K.	18.00
BEARTOOTH DRIVE	2.30 N	2.75 N	1.85 S	2.60 S	1.00 N	1.00 B.O.K.	18.00
SUNDANCE BOULEVARD	2.30 N	2.75 N	1.85 S	2.60 S	1.00 N	1.00 B.O.K.	20.00

\* DENOTES EXISTING SERVICE EXACT LOCATION TO BE PROVEN ON SITE BY CONTRACTOR. ALL OFFSETS ARE REFERENCED TO NEAREST BL.

### LEGEND

- GW - PROPOSED GAS & WATER CONDUITS
- ET - PROPOSED ELECT. & TELECOMM. CONDUITS
- W - PROPOSED WATER MAIN
- ExW - Ex. WATER MAIN
- G - PROPOSED GAS MAINS
- ExG - Ex. GAS MAINS & VALVE
- E - PROP. ELECTRICAL CABLES
- ExE - Ex. ELECTRICAL CABLE
- C - PROPOSED COMMS CABLES
- ExC - Ex. COMMS CABLES
- Proposed Drain & Pit
- Ex. Drain & Pit
- Proposed House Drain
- Ex. House Drain
- 109.0 - DESIGN FINISHED SURFACE CONTOURS (0.25m INT.)
- Direction of Lot Finished Surface Fall
- Overland Flow Path
- 1.0m RW - PROPOSED RETAINING WALL AND HEIGHT. REFER TO STRUCTURAL DRAWING PRODUCED BY JV CONSULTING. NOTE: RETAINING WALL SLEEPERS ARE TO SPAN THE FULL WIDTH OF THE EASEMENTS WHERE CROSSING WITH OTHER EASEMENTS. NO POSTS WITHIN THIS AREA.

### DRAINAGE PIT LEGEND

- EP - END PIPE
- JP - JUNCTION PIT
- SEP - SIDE ENTRY PIT
- WW - WINGWALL
- GSEP - GRATED SIDE ENTRY PIT

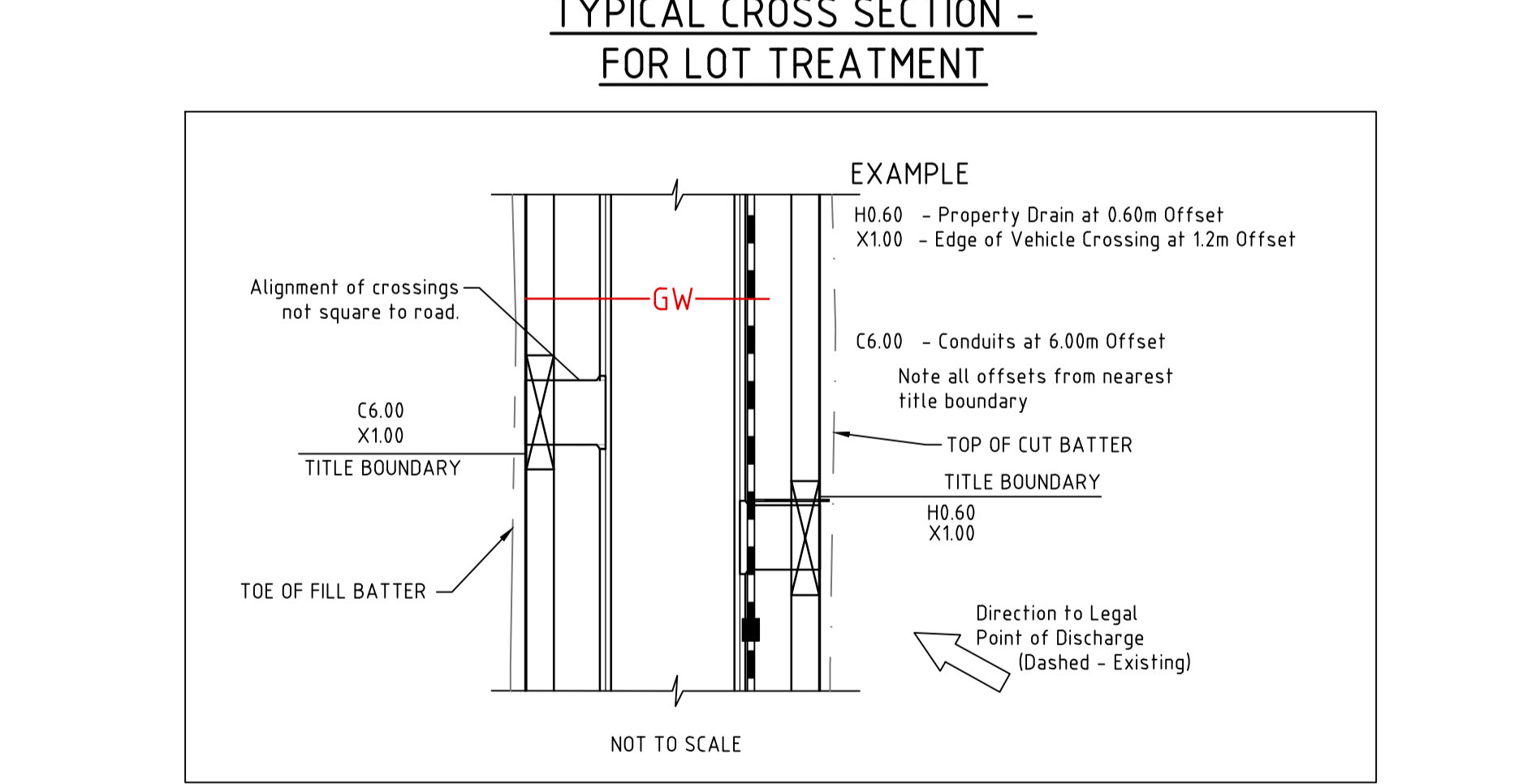
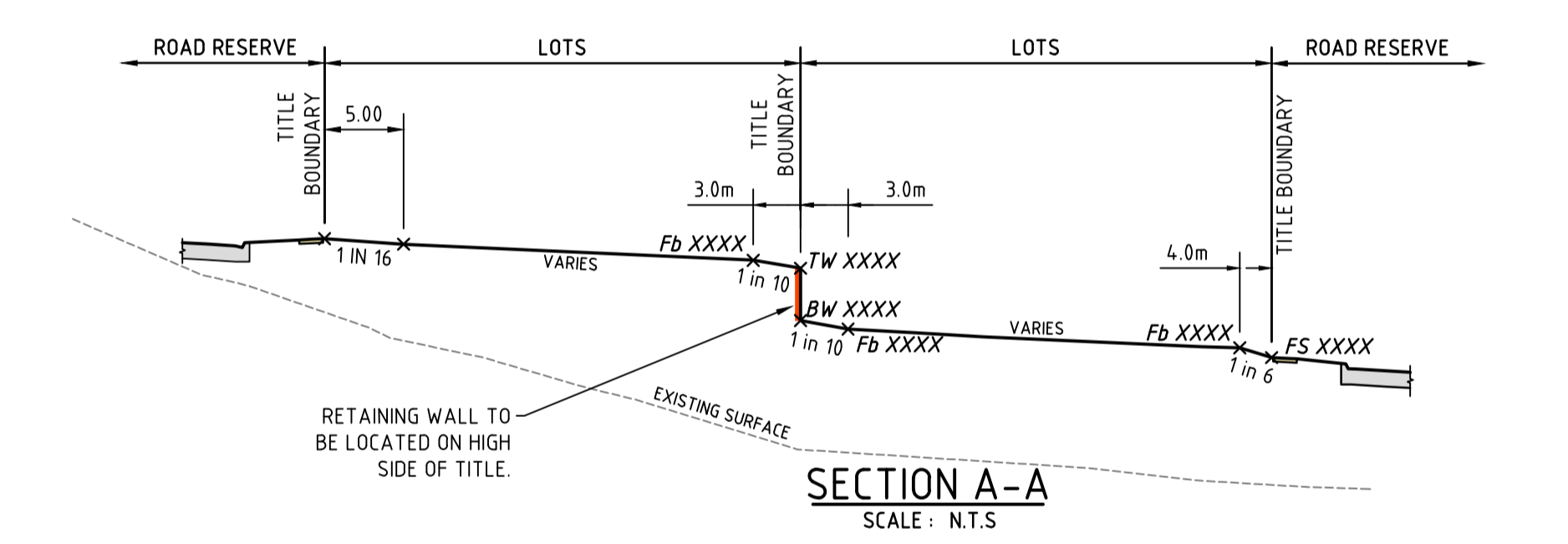
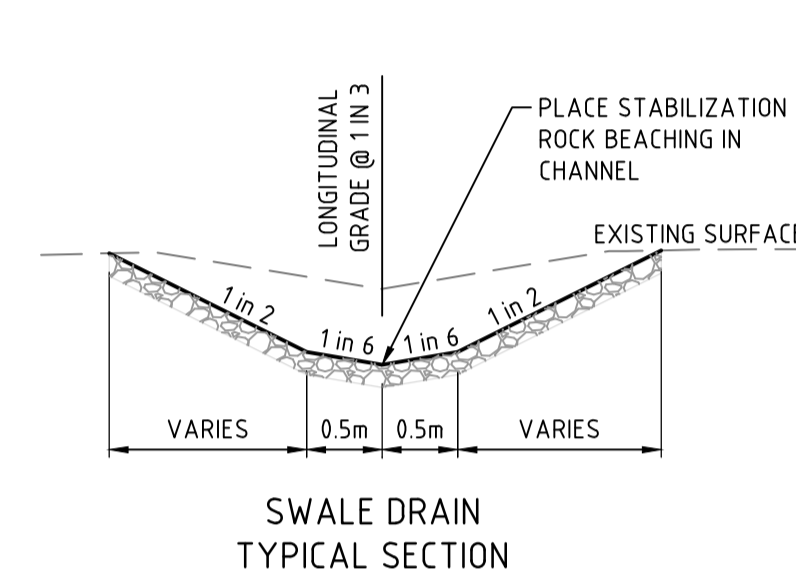

### WARNING

BEWARE OF UNDERGROUND SERVICES  
 THE LOCATIONS OF UNDERGROUND SERVICES ARE APPROXIMATE ONLY AND THEIR EXACT POSITION SHOULD BE PROVEN ON SITE. NO GUARANTEE IS GIVEN THAT ALL EXISTING SERVICES ARE SHOWN.

### AS-CONSTRUCTED PLAN

THIS PLAN HAS BEEN PREPARED TO REFLECT THE WORKS AS PRESENTED AT END OF SUBDIVISION CONSTRUCTION. THE PLAN IS NOT BASED ON SURVEY OF THE COMPLETED WORKS. ALL LEVELS, CO-ORDINATES AND SERVICE LOCATIONS SHOWN ON THE PLANS ARE THE DESIGN INFORMATION AND SHOULD NOT BE RELIED UPON BY ANY FUTURE PARTY IN RELATION TO DETAILED DESIGN ACTIVITIES. THESE PLANS ARE PROVIDED TO COUNCIL FOR ASSET MANAGEMENT PURPOSES AND ANY USE OF THE PLANS BY THIRD PARTIES IS NOT PERMITTED. ANY SUBSEQUENT DESIGN OR CONSTRUCTION ACTIVITIES IN THE AREA DEFINED ON THESE PLANS WILL REQUIRE ADDITIONAL SITE SURVEY AND ASSET PROVING BY THE RELEVANT PARTY.

VERSION	REMARKS	VERSION	REMARKS
E	CONSTRUCTION ISSUE	14.05.21	LP
D	REVELSTOKE WAY ELECTRICAL AND NBN OFFSET	29.04.21	LP
C	DRAWING SET UPDATED	31.03.21	LP
B	ISSUED TO COUNCIL	27.01.21	LP
A	PRELIMINARY ISSUE	13.01.21	LP

DATE	BY	DATE	BY
03.05.22	LP	03.05.22	LP
14.04.22	LP	14.04.22	LP
11.10.21	LP	11.10.21	LP

DRAWN BY: N. ROBINSON  
 DESIGNED BY: L. PHAN  
 CHECKED BY: P. MILLER  
 AUTHORIZED BY: P. MILLER

REEDS CONSULTING  
 LAND SURVEYING  
 CIVIL ENGINEERING  
 PLANNING  
 DEVELOPMENT CONSULTING

CITY OF BALLARAT  
 WINTERFIELD ESTATE, WINTER VALLEY  
 STAGE 11  
 LAYOUT PLAN

11R2  
 23718E/11  
 SHEET 2 OF 27