

**EXISTING TREES AND FENCES:**

- ALL EXISTING TREES ARE TO BE REMOVED AS PER TREES REMOVAL REPORT
- ALL EXISTING FENCES ARE TO BE REMOVED AS SHOWN WITHIN THE DEVELOPMENT BOUNDARY

**EARTHWORKS LEGEND**

- FILL EARTHWORKS - FILL AREA WITHIN LOTS GREATER THAN 150mm DEPTH
- CUT EARTHWORKS - CUT AREA WITHIN LOTS GREATER THAN 150mm DEPTH

THIS PLAN SHOWS ONLY APPROXIMATE EXTENTS & LEVELS OF FILL TO BE PLACED DURING CONSTRUCTION. DEPTH OF FILL USED FOR TOP DRESSING ALL ALLOTMENTS MAY VARY BY UP TO 0.15m. THE EXTENT OF FILL SHOWN IS BASED ON DESIGN AND MAY BE SUBJECT TO CHANGE FOLLOWING FINAL INSPECTION BY GEOTECHNICAL ENGINEER.

**LEGEND**

- PROPOSED GAS & WATER CONDUITS
- PROPOSED ELECT. & TELECOMM. CONDUITS
- PROPOSED WATER MAIN
- Ex. WATER MAIN
- PROPOSED GAS MAINS
- Ex. GAS MAINS & VALVE
- PROP. ELECTRICAL CABLES
- Ex. ELECTRICAL CABLE
- PROPOSED COMMS CABLES
- Ex. COMMS CABLES
- PROPOSED DRAIN & PIT
- Ex. DRAIN & PIT
- PROPOSED HOUSE DRAIN
- Ex. HOUSE DRAIN
- PROPERTY INLET
- PSM
- TBM
- DIRECTIONAL WARNING TACTILES
- DIRECTION OF LOT FINISHED SURFACE FALL
- OVERLAND FLOW PATH

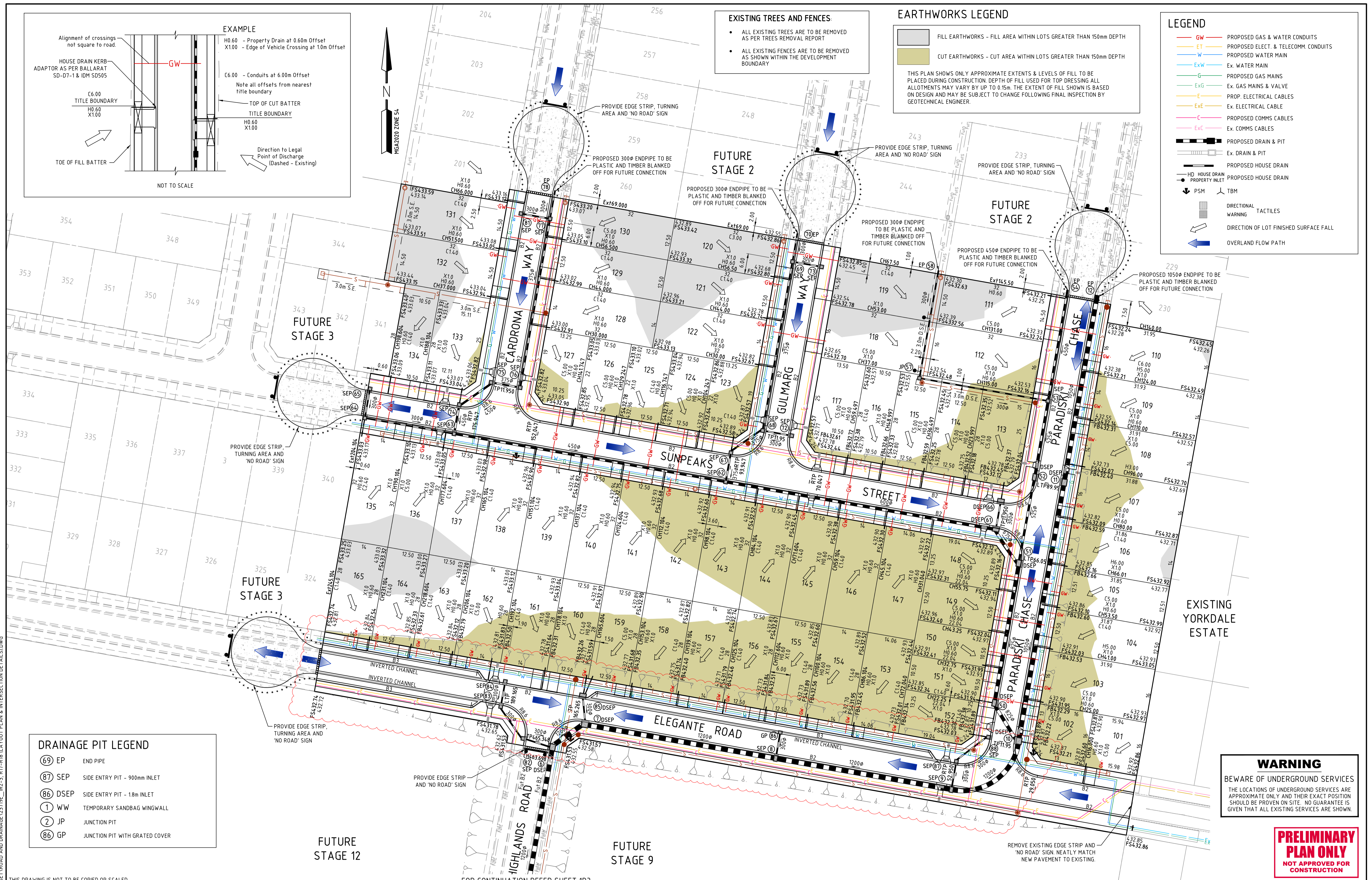

**DRAINAGE PIT LEGEND**

- 69 EP END PIPE
- 87 SEP SIDE ENTRY PIT - 900mm INLET
- 86 DSEP SIDE ENTRY PIT - 18m INLET
- 1 WW TEMPORARY SANDBAG WINGWALL
- 2 JP JUNCTION PIT
- 86 GP JUNCTION PIT WITH GRATED COVER

**WARNING**

BEWARE OF UNDERGROUND SERVICES

THE LOCATIONS OF UNDERGROUND SERVICES ARE APPROXIMATE ONLY AND THEIR EXACT POSITION SHOULD BE PROVEN ON SITE. NO GUARANTEE IS GIVEN THAT ALL EXISTING SERVICES ARE SHOWN.

**PRELIMINARY PLAN ONLY**

NOT APPROVED FOR CONSTRUCTION

THIS DRAWING IS NOT TO BE COPIED OR SCALED

VERSION	REMARKS	DATE	BY
F	PARKING BAY ADDED TO ELEGANTE ROAD	10.05.23	LP
D	RESPONSE TO COUNCIL COMMENTS	23.03.23	LP
E	RESPONSE TO COUNCIL COMMENTS	29.11.22	LP
C	TENDER ISSUE	15.08.22	MW
B	PRELIMINARY ISSUE	21.07.22	MW

FUTURE STAGE 12

FUTURE STAGE 9

FOR CONTINUATION REFER SHEET 1R3

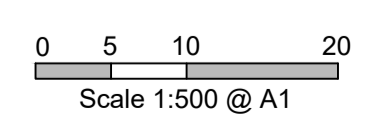

DRAWN BY	N. KASHA	DESIGNED BY	M. WEE
MELWAY	565, N10	CHECKED BY	L. PHAN
DATUM	AHD	AUTHORISED BY	T. HOI

**REEDS CONSULTING**

LAND SURVEYING CIVIL ENGINEERING

DEVELOPMENT CONSULTING

www.reedsconsulting.com.au

Level 16, 501 Swanston Street Melbourne

Copyright © Reeds Consulting Pty Ltd. All Rights Reserved 2021

CITY OF BALLARAT		DRAWING No.	VERSION
WINTERFIELD NORTH ESTATE		1R2	F
STAGE 1 LAYOUT PLAN		REFERENCE	23719E/1
		SHEET	2 OF 25